

NOTES:

- 1) REFERENCE CONNECTOR TO BE CONNECTED TO MCC PREFABRICATED CABLE
- 2) AUDIO PATCH CABLE LENGTH TO BE 15" MINIMUM FROM END OF MODULE.
BNC CABLE LENGTH TO BE 15" MINIMUM FROM END OF MODULE.
03-6-2023 CABLE LENGTH TO BE 15" MINIMUM FROM END OF MODULE.
- 3) P/N OF MOLEX
- 4) WEIGHT: 0.25 LBS
- 5) CURRENT CONSUMPTION: 0.10A PEAK
- 6) FEMALE RCA PATCH CABLES WILL BE USED AUDIO CONNECTION
- 7) COAX CABLE WILL BE RG58 WITH A CA-BNC136 CONNECTOR

REVISIONS				
ZONE	REV	DESCRIPTION	DATE	APPROVED

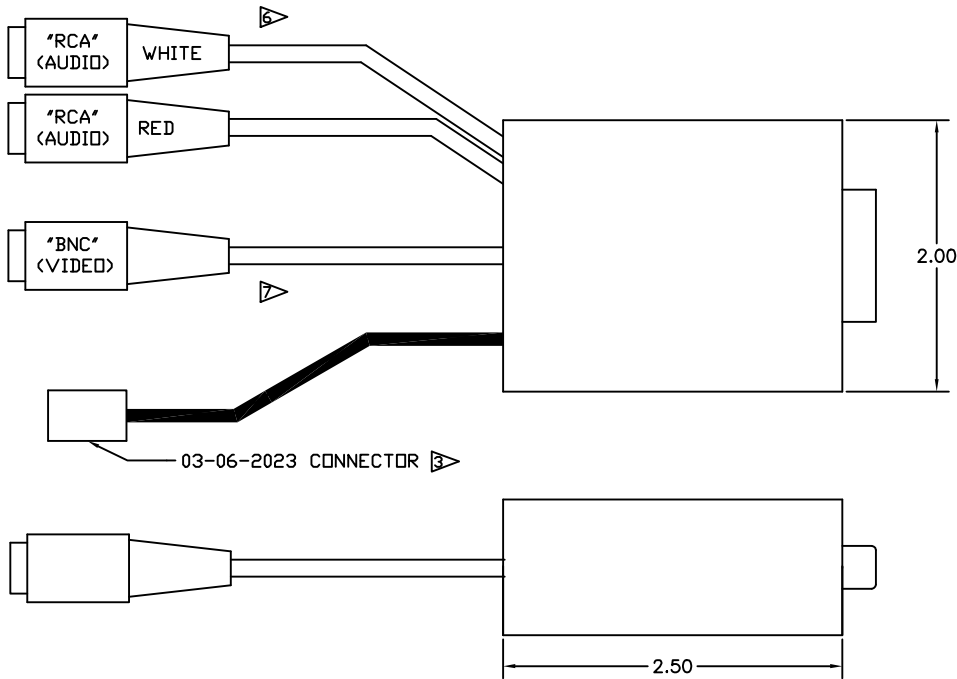

PART NUMBER	DESCRIPTION
03-06-2023	CONNECTOR
03-06-1023	MATING CONNECTOR

WIRE DESCRIPTION		
PIN	DESCRIPTION	CIRCUIT TYPE
1	+28VDC	POWER INPUT
2	GND	POWER RETURN

PART NUMBER	DESCRIPTION
5011W1PCT88A30X	CONNECTOR
5011W1SXK99A10X	MATING CONNECTOR

WIRE DESCRIPTION		
PIN	DESCRIPTION	
1	SOURCE1 LEFT (+)	PREFAB CABLE REF. 108001
2	SOURCE1 RIGHT (+)	
3	INFRARED DATA OUTPUT	
4	INFRARED DATA RETURN	
5	SE1 DATABUS (B)	
6	SE1 DATABUS (D)	
7	SOURCE1 LEFT (-)	
8	SOURCE1 RIGHT (-)	
9	SE1 DATABUS (A)	
10	SE1 DATABUS (C)	
A1	VIDEO SOURCE1 (SIGNAL)	

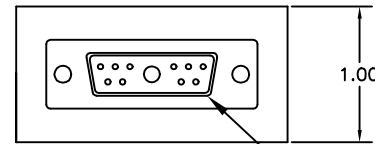

5011W1PCT88A30X
DNEC CONNECTOR

① SOURCE EQUIPMENT

THIS DRAWING CONTAINS PROPRIETARY INFORMATION AND TECHNICAL MATERIAL THAT ARE THE SOLE PROPERTY OF MID CONTINENT CONTROLS, INC. THIS MATERIAL SHOULD BE TREATED AS CONFIDENTIAL BY ITS RECIPIENT AND SHOULD NOT BE SHOWN OR DISCLOSED TO ANY ORGANIZATION OR PERSON WITHOUT FIRST OBTAINING WRITTEN PERMISSION FROM MID CONTINENT CONTROLS, INC.

Mid Continent Controls, Inc. (316)789-0088
901 North River, Derby, KS 67037

SOURCE EQUIPMENT ADAPTER MODULE

FINISH: BLACK ANODIZE

MATERIAL: N/A

TOLERANCE: ±0.010" UNLESS NOTED

SIZE B	DRAWN MFS	DWG NO. 106060	REV IR
SCALE N/A	DATE 4/12/2002	SHEET 1 OF 1	