

NOTES:

- AUDIO INPUTS ARE LINE LEVEL ONLY: 0.5Vpp TO 2Vpp.
- OUTPUT LEVELS TBD.
- PA AUDIO INPUT IS AN AUDIO COUPLING TRANSFORMER. IMPEDANCE = 600 OHMS  
PA AUDIO IS PRIORITY ON ALL OUTPUTS WHEN PA KEY IS GROUNDED.  
PA TRIM ADJUSTMENT IS PROVIDED FOR LEVEL MATCHING DURING SWITCHING OPERATIONS.
- CHANNEL SELECT PIN OPERATION:  
WHEN THIS PIN IS FLOATING SOURCE 1 AUDIO IS PASSED TO THE OUTPUT.  
WHEN THIS PIN IS GROUNDED SOURCE 2 AUDIO IS PASSED TO THE OUTPUT.
- CHIME KEY INPUTS PROVIDE APPROXIMATELY A THREE(3) SECOND MUTE TO OUTPUTS WHEN ACTIVATED.  
ACTIVE LOW AND ACTIVE HIGH INPUTS ARE AVAILABLE. SIGNAL MUST BE REMOVED TO RESET THIS FEATURE.
- SOURCE TRIM ADJUSTMENTS ARE PROVIDED FOR LEVEL MATCHING DURING SWITCHING OPERATIONS.
- AUDIO INPUTS ARE ISOLATED. IMPEDANCE = 10K OHMS.

REVISIONS				
ZONE	REV	DESCRIPTION	DATE	APPROVED
ALL	A	REDRAWN WITH CHANGES	04/13/97	RAH
4D	B	CHANGED CHIME OPERATION	08/07/97	RAH
2D		1) CHANGED PIN DESIGNATION PIN 4 WAS: 'CHIME KEY' PIN 6 WAS: 'NC' 2) CHANGED NOTE 5.		
4D	C	ISOLATED AUDIO INPUTS	03/06/98	DLS
2D		1) CHANGED PIN DESIGNATION PIN 7,10,19,22 WAS: 'AUDIO COMMON' 2) ADDED NOTE 7.		

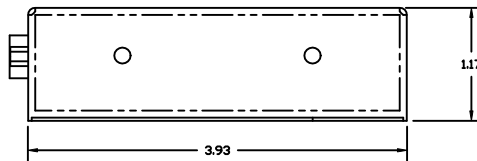
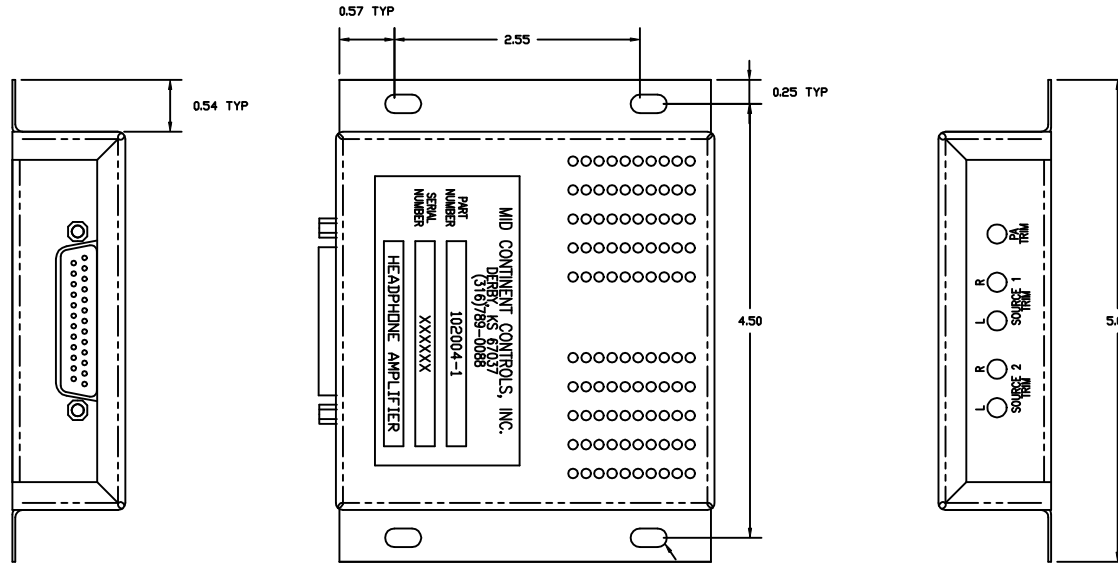

CONNECTOR DESCRIPTION	
PART NUMBER	DESCRIPTION
D38A25P	CONNECTOR
R20A18-2	JACK POST
WIRE DESCRIPTION	
PIN	DESCRIPTION
1	28VDC
2	GROUND
3	PA AUDIO -
4	CHIME KEY (ACTIVE LOW)(XGND IN)
5	CHANNEL 1 SELECT
6	CHIME KEY (ACTIVE HIGH)(+28VDC)
7	LEFT -> INPUT
8	LEFT +> INPUT
9	RIGHT -> INPUT
10	RIGHT +> INPUT
11	AUDIO COMMON
12	L+ OUTPUT
13	R+ OUTPUT
14	AUDIO COMMON
15	PA AUDIO +
16	PA KEY
17	CHANNEL 2 SELECT
18	AUDIO COMMON
19	LEFT -> INPUT
20	LEFT +> INPUT
21	RIGHT -> INPUT
22	RIGHT +> INPUT
23	AUDIO COMMON
24	L+ OUTPUT
25	R+ OUTPUT

THIS DRAWING CONTAINS PROPRIETARY INFORMATION AND TECHNICAL MATERIAL THAT ARE THE SOLE PROPERTY OF MID CONTINENT CONTROLS, INC. THIS MATERIAL SHOULD BE TREATED AS CONFIDENTIAL BY ITS RECIPIENT AND SHOULD NOT BE REPRODUCED OR DISCLOSED TO ANY ORGANIZATION OR PERSON WITHOUT FIRST OBTAINING WRITTEN PERMISSION FROM MID CONTINENT CONTROLS, INC.		Mid Continent Controls, Inc. (316)789-0088 219 S. Water, Derby, KS 67037	
HEADPHONE AMPLIFIER			
FINISH: BLACK ANODIZE		SIZE C	DRAWN RAH
MATERIAL: NA	DWG NO. 102004	REV C	
TOLERANCE: ±0.010* UNLESS NOTED	SCALE FULL	DATE 03/17/97	SHEET 1 OF 1